

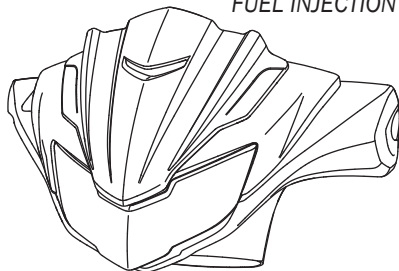

VISOR INSTALLATION MANUAL

TECHNICAL

FUEL INJECTION



Tekhne is inspired by the Greek word 'technê' (pronunciation: /'te.xni/), meaning art, craft, technique, or skill.

Products offered by Tekhne are specially crafted to meet the needs and expectations of consumer's machines (motorcycles) – performance and reliable parts with cutting-edge technology.

The colours are specifically chosen to further emphasize what the brand stands for:

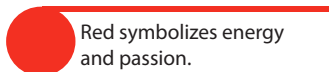

Red symbolizes energy and passion.



Blue represents intelligence, innovation and reliability.

BOX CONTENTS

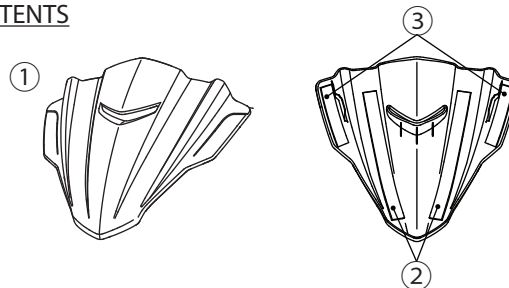

NO	PART NAME	QTY
①	Visor	1
②	Tape 1 (Pre-installed)	2
③	Tape 2 (Pre-installed)	2

ASSEMBLY INSTRUCTIONS



Precaution

1. Carefully follow the instructions to prevent incorrect assembly.
2. Avoid removing the visor after affixing onto bike.
3. Avoid washing the visor for 24 hours after affixing.

STEP 1: Clean taping area from dirt and dust

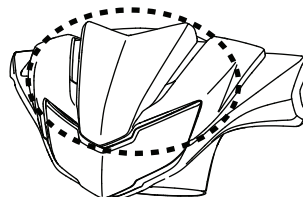

STEP 2: Remove double tape liner

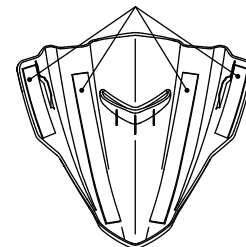

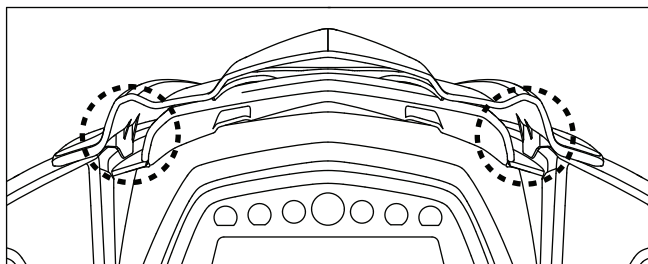
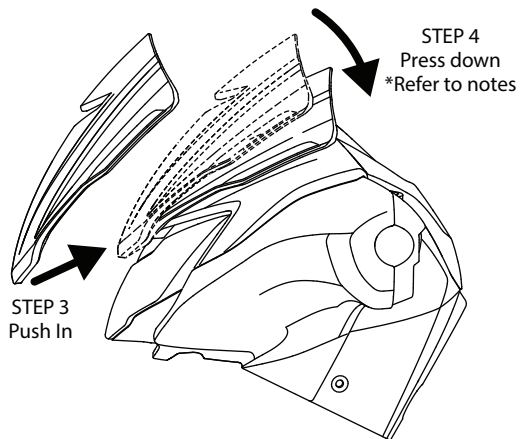

STEP 4 notes:

1. Use the guide structure to make sure the Visor is centered.
2. Press the Visor firmly until the tape is stick completely.

